



**PREMIUM LIST**

ENTRIES OPEN: 8:00 AM MDT, Wednesday, January 23, 2019  
ENTRIES CLOSE: 8:00 PM MDT, Wednesday, March 6, 2019

**Four All-Breed and Mixed Breed Obedience Trials**  
Indoors, 1 ring on partially mat-covered carpet

Saturday (1)	March 23, 2019	Event #2019009505
Saturday (2)	March 23, 2019	Event #2019009506
Sunday (3)	March 24, 2019	Event #2019009507
Sunday (4)	March 24, 2019	Event #2019009508

**Four All-Breed and Mixed Breed Rally® Trials**  
Indoors, 1 ring on partially mat-covered carpet

Saturday (1)	March 23, 2019	Event #2019009501
Saturday (2)	March 23, 2019	Event #2019009502
Sunday (3)	March 24, 2019	Event #2019009503
Sunday (4)	March 24, 2019	Event #2019009504

**Best Western Plus**

1325 N. 7<sup>th</sup> Ave. Bozeman, MT 59715

Trial Hours: Saturday and Sunday 7:00 AM to 5:00 PM

Entries are limited to 8 hours of judging per judge each day.

CERTIFICATION 

Permission has been granted by the American Kennel Club for the holding of these events under American Kennel Club Rules and Regulations. ~James P. Crowley, Secretary

**GALLATIN DOG CLUB  
OFFICERS**

President ..... Becky Roeder  
Vice President ..... Von Jelberg  
Treasurer ..... Christie Leone  
Secretary ..... Mary Ann Norman

**BOARD OF DIRECTORS**

Richard Vincent, LuAnn Rod, Carol Steadman

**TRIAL SECRETARY**

Ellen Calnan  
3752 Rodeo Rd., Missoula, MT 59803  
Email: [RedTileServices@gmail.com](mailto:RedTileServices@gmail.com) ♦ phone: 406-544-2418  
(Email or text are preferred.)  
[www.RedTileK9Events.com](http://www.RedTileK9Events.com)

**TRIAL COMMITTEE**

Obedience Chair.....Becky Roeder  
27 Sundance Trail, Bozeman, MT 59718  
[broedster@aol.com](mailto:broedster@aol.com) 406-570-5223  
Rally Chair.....Christie Leone  
301 Valley Grove Dr, Bozeman, MT 59718  
[agilitybmd@gmail.com](mailto:agilitybmd@gmail.com) 406-581-8658  
Chief Ring Steward..... Jeanette Prevel  
Emergency Coordinator .....Christie Leone

**OBEDIENCE and RALLY JUDGES**

Mr. Laurence J. Libeu, (1333) 1040 N Refugio RD, Santa Ynez, CA 93460-9316  
Mr. Melvin R. Stanley (17183), 2544 N 1500 W, Clinton UT 84015-8316

**GALLATIN DOG CLUB Inc.** (Licensed by the American Kennel Club)  
[www.gallatindogclub.com](http://www.gallatindogclub.com) (additional entry forms available for download)

**ONLINE ENTRIES!**  
See **“Special Notices”** section for details.

<p><b>Veterinarian – On Call</b> Banfield – The Pet Hospital In <b>Petsmart</b> 2997 Max Ave, Bozeman, MT 59718 406-586-0334</p>	<p><b>Pet Emergency Trauma Services</b> 1103 Reeves Road West 19<sup>th</sup> Ave. Exit North off I-90 (Located in Springhill Plaza, next to the Blue Basket.) M-Th 5:30 PM – 7:30 AM Fri 5:30 PM through Monday 7:30 AM 406-587-3996</p>
--	---

## SPECIAL NOTICES

### ONLINE ENTRIES! ONLINE ENTRIES!

If you prefer the convenience and confidence of online entry for dog events, you are in luck! You may enter online at [www.RedTileK9Events.com](http://www.RedTileK9Events.com). You may also order a catalog at the website. You do NOT have to enter online in order to pay for a catalog.

#### For Mailed Entries:

Entries received without full fees will not be accepted. GDC, the trial committee and the trial secretary assume no responsibility for wrong or incomplete information given on entry blank by the owner or agent of the owner. Returned checks do not constitute a valid entry.

**Make Checks and Money Orders payable to:** Gallatin Dog Club (or GDC), payable in US Dollars ONLY.

**Telegraph, Telephone, Faxed, Conditional and Unsigned Entries cannot be accepted.** Entries not on official AKC entry forms and photocopies of entry Forms without Agreement and Rules on the reverse side of the Official AKC Entry Form are NOT ACCEPTABLE. Entry forms which are incomplete or illegible will not be accepted. Entries sent by “special delivery” (UPS or FEDEX) **MUST** be sent “no signature required.”

**CONFIRMATIONS and JUDGING PROGRAM** If you provide a valid email address on your entry form, you will receive a preliminary confirmation soon after your entry is received and processed, and the final confirmation and Judging Program will be sent by email soon after the closing date. If an email address is NOT provided, you will not receive a preliminary confirmation. The final confirmation and judging program will be sent by US Mail after the closing date.

#### ENTRY FEES

##### Obedience and Rally Trial Fees

First Entry of Each Dog per Trial .....	\$28.00*
Additional Entry of Same Dog in Same Trial.....	\$21.00*
Junior Handler per entry/per trial .....	\$10.00*

\*Entry fees include \$3.50 AKC Event Service Fee.

**CATALOGS** Check box on entry forms for a prepaid catalog and add \$10.00 to fees; a limited number will be available for purchase for \$15.00 the day of the trial.

**Refunds will be given** (minus \$3.00 for each class entered) for bitches in season after closing date. BIS refund requests must be delivered in writing (or email) to the trial secretary no later than 30 minutes before the start of the first class on Saturday, and must be accompanied by certification by a veterinarian that the bitch is in season.

## SPECIAL NOTICES (cont.)

**Entry fees will not** be refunded in the event that a dog is absent, disqualified, sick, lame, excused by veterinarian or judge, barred from competition by action of the Trial Committee, or because the dog is ineligible to compete due to being entered incorrectly. No entry fees will be refunded if the Trial cannot open or be completed by reasons beyond the control of the Trial Committee.

**TRANSFERS WILL BE ALLOWED AT THESE OBEDIENCE & RALLY TRIALS** as described in Chapter 1, section 16a of the obedience regulations. Class transfer requests must be submitted in writing to the Trial Secretary at least 30 minutes prior to the start of judging at the trial, and are subject to the availability of the class and judge. “Availability of the class” means it appears in the judging schedule for the trial, NOT the premium. Stated another way; a class is available to transfer into only if it received at least one entry before closing.

**Exhibitors should follow** their veterinarians’ recommendation to assure their dogs are free of internal and external parasites, and communicable diseases, and have appropriate vaccinations.

**Neither the Trial Committees nor the Trial-giving Club** will be responsible for the loss or damage to any dog on the trial grounds, whether as a result of an accident or any other cause. It is clearly understood that every dog entered in the trial is in the care, custody and control of its owner or handler during the entire time the dog is on the trial premises. By entering this show, exhibitors and agents agree to maintain orderly conditions.

Any arguing or abusive language may result in forfeiture of all privileges, without refund of fees. Such actions may be subject to disciplinary action by the Trial Committee.

**CRATING** – Indoor crating is available in the designated Crating Areas in the foyer outside the Rally Room and in the Aspen and Tamarack Rooms. Set up will be available from 6:00 – 7:00 PM on Friday and at 7:00 AM on Saturday and Sunday. Crates may be left overnight but **no dogs are allowed in the crating areas overnight**. The Rally room and the Aspen and Tamarack rooms will be locked 1 hour after last class of the day. All crates and personal belongings must be removed from the trial site no later than 1 hour after the last class on Sunday. **Absolutely no X-pens** are allowed in crating areas. Noisy or disruptive dogs will be required to leave the crating areas. Crating is a privilege that may be withdrawn for those who violate rules or instructions of the Trial Committee.

**Dogs not competing in the current class must be crated when in Crating Areas or in your own hotel room. No dogs or crates of any kind will be allowed in Spectator areas.**

**Please keep all dogs on leash** or otherwise confined except when in the ring or designated exercise areas. Please clean up after your dogs.

**FOOD:** There is a full service restaurant on site.

**CLASSES OFFERED and JUDGING ASSIGNMENTS**

<b>CLASSES</b>	<b>Saturday Trial #1</b>	<b>Saturday Trial #2</b>	<b>Sunday Trial 3</b>	<b>Sunday Trial 4</b>
<b>Beginner Novice A, B</b>	Stanley	Libeu	Libeu	Stanley
<b>Novice A, B</b>	Stanley	Libeu	Libeu	Stanley
<b>Preferred Novice</b>	Stanley	Libeu	Libeu	Stanley
<b>Open A, B</b>	Libeu	Stanley	Stanley	Libeu
<b>Preferred Open</b>	Libeu	Stanley	Stanley	Libeu
<b>Utility A, B</b>	Libeu	Stanley	Stanley	Libeu
<b>Preferred Utility</b>	Libeu	Stanley	Stanley	Libeu
<b>Graduate Novice</b>	Libeu	Stanley	Stanley	Libeu
<b>Graduate Open</b>	Libeu	Stanley	Stanley	Libeu
<b>Versatility</b>	Libeu	Stanley	Stanley	Libeu
<b>Rally Novice A, B</b>	Stanley	Libeu	Libeu	Stanley
<b>Rally Advanced A, B</b>	Stanley	Libeu	Libeu	Stanley
<b>Rally Excellent A, B</b>	Stanley	Libeu	Libeu	Stanley
<b>Rally Intermediate</b>	Stanley	Libeu	Libeu	Stanley
<b>Rally Master</b>	Stanley	Libeu	Libeu	Stanley

**Ring conflicts** resulting from a handler having entries in multiple classes will be resolved as best as possible by handler request to the ring stewards when the run orders are posted ring-side. When necessary, obedience runs, including group exercises, will be given precedence over rally runs.

**Obedience Trial Classes**

Open and Utility Entries Must Include Dog's Jump Height.

**Rally Trial Classes**

Rally Advanced and Excellent Entries Must Include Dog's Jump Height.

In both rings, judging begins at **8:00 AM on Saturday and Sunday**.

Obedience and Rally judging will take place **concurrently**.

## AWARDS and PRIZES

Qualifying scores are required for all awards in regular and optional titling classes; unless noted otherwise. A prize or award of equal value will be substituted in the event that a specific award/prize is unavailable. All prizes and awards must be claimed in the ring or at the Trophy Table by one hour after the last class concludes on Sunday, none will be mailed. All dogs earning their OTCH at this trial will receive an OTCH ribbon and all dogs earning their RACH at this trial will receive a RACH ribbon. If you are close to earning one of these awards, please let the Trial Secretary know so we can have the ribbon available and celebrate with you.

### OBEDIENCE RIBBON PRIZES (Regular & Optional Titling Classes)

First..... Blue Ribbon  
 Second Place..... Red Ribbon  
 Third Place..... Yellow Ribbon  
 Fourth Place..... White Ribbon  
 All Qualifying Scores ..... Green Ribbon

High Scoring Dog in Regular Classes ..... Rosette  
 High Combined Score in Open B  
 And Utility Classes ..... Rosette

### RALLY RIBBON PRIZES

First..... Blue Ribbon  
 Second Place..... Red Ribbon  
 Third Place..... Yellow Ribbon  
 Fourth Place..... White Ribbon  
 All Qualifying Scores ..... Green Ribbon

High Combined Score in Adv B  
 And Exc B Classes ..... Rosette  
 High Combined Score in Adv B  
 And Exc B and Master Classes..... Rosette

### Offered by GALLATIN DOG CLUB:

One toy will be given to each dog entered in the trials (valued at \$3-4.00)

The sketch below shows expected layout of rings and crating at site.

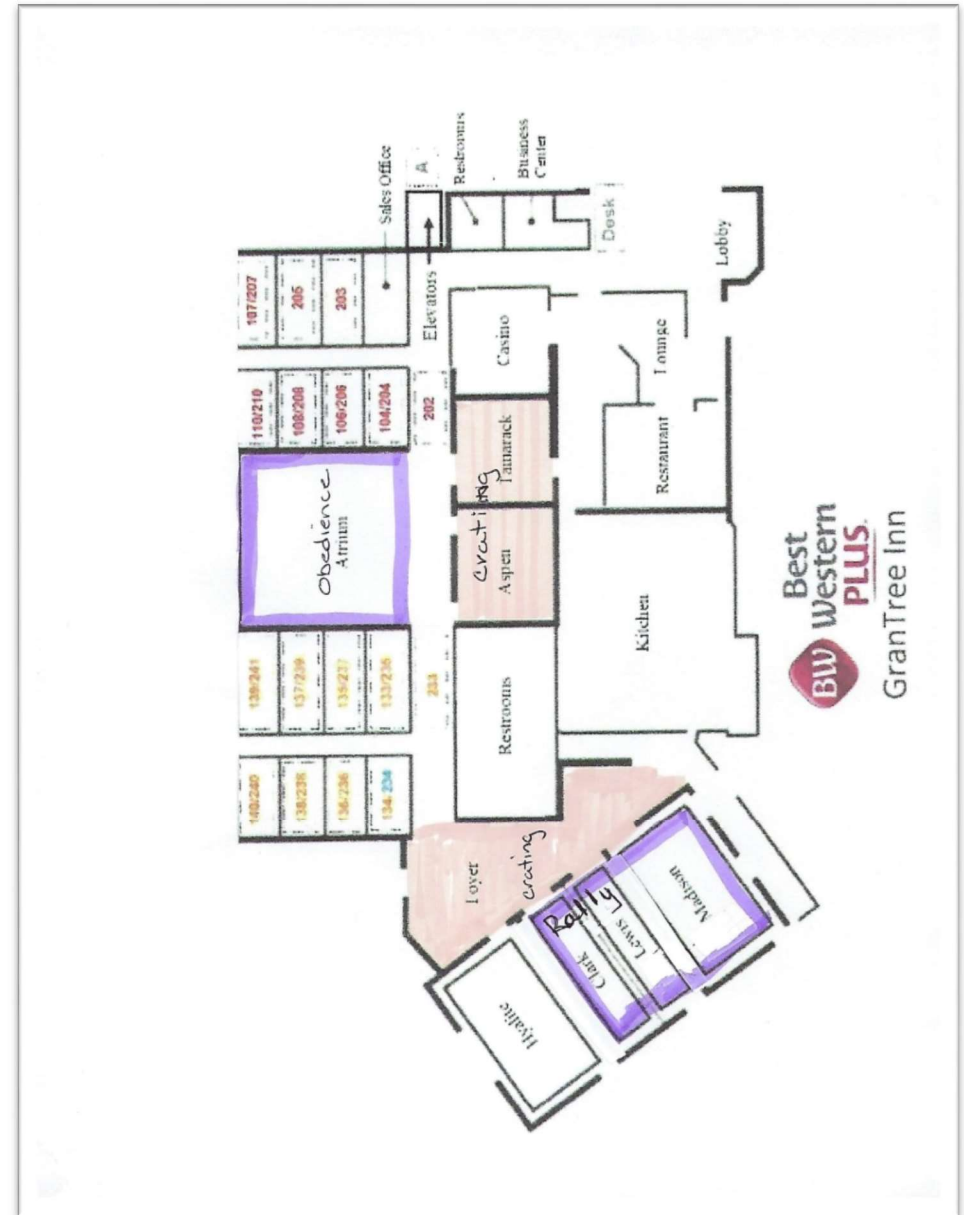

## Accommodations

The following properties have indicated in the past that they will accept guests with dogs. Please confirm when making reservation. PLEASE help us keep these properties for other events by respecting their property and by picking up after your dog, by not leaving dogs unattended in rooms, and by not allowing your dog to disturb other guests.

## HOST HOTEL and LOCATION OF TRIALS

### Best Western Plus – Grantree Inn

1325 North 7<sup>th</sup> Ave, Bozeman, MT 59715  
406-587-5261

The Gallatin Dog Club has negotiated a special rate of **\$93.00/night** (+ taxes). To reserve, call (406) 587-5261. At beginning of call, mention “Gallatin Dog Club” or “GVDS0319” to secure the negotiated rate.

The rate is **guaranteed only until February 22, 2019** and the property recommends reservations be made as soon as possible. Reservations may be cancelled without penalty up to 24 hours prior to scheduled arrival.

Other properties (all in Bozeman, MT 59715):

<b>Western Heritage Inn</b>	1200 E Main St	406-586-8534
<b>Comfort Inn</b>	1370 N. 7 <sup>th</sup>	406-587-2322
<b>Days Inn</b>	1321 N 7 <sup>th</sup>	406-587-5251
<b>Microtel Inn</b>	612 Nikles Dr.	406-586-3797
<b>Super 8 Motel</b>	800 Wheat Dr.	406-586-1521

**Camping at the Trial:** Day parking for RVs is available at the hotel. No overnight RVs at the hotel.

Bozeman Hot Springs & Campground is located about 10 miles from the hotel.  
81123 Gallatin Rd (Hwy 191), Bozeman, 59718  
406-587-3030 | <http://bozemanhotsprings.co/bozeman-campground/>

## MAP and DIRECTIONS TO SITE

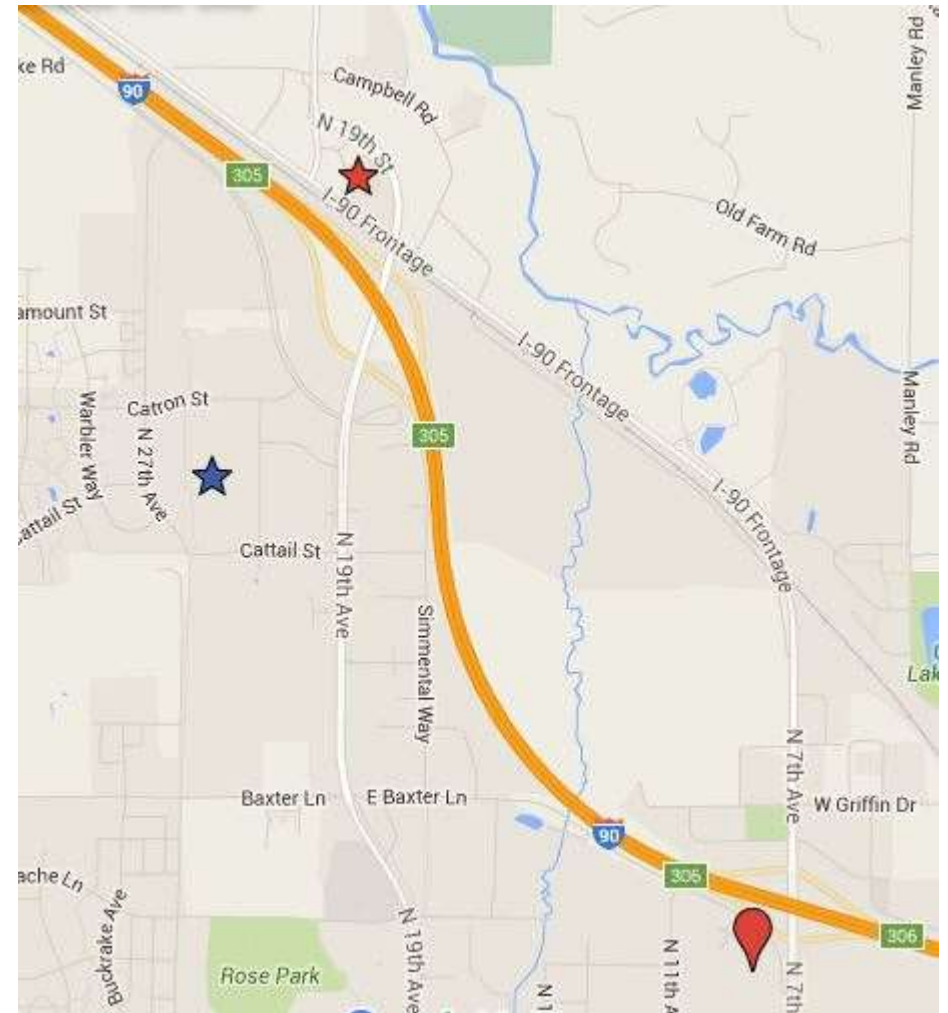

The **Best Western Plus – Grantree Inn** is located on the corner of Baxter and 7th Ave, one block south of Interstate 90

- From I-90 take Exit 306/7th Ave.
- Travel one block south to Baxter Lane.
- Right onto Baxter Lane; hotel is the first building on your left

★ Petsmart (Banfield Pet Hospital)  
2997 Max Avenue  
406-586-0334

★ Pet Emergency Trauma Services  
1103 Reeves Road West  
406-587-3996

OFFICIAL ENTRY FORM — GALLATIN DOG CLUB —

Entries close at 8:00 PM, Wednesday, March 6, 2019

Mail to: Ellen Calnan, 3752 Rodeo Rd., Missoula, MT 59803 Fees payable to:GDC

OBEDIENCE: Enter fee amount in each box		Enter fee amount in each box	
Saturday (1)	First OBED Entry (\$28)	\$	Add'l Sat OBED (1) entries, same dog (\$21) each
Saturday (2)	First OBED Entry (\$28)	\$	Add'l Sat OBED (2) entries, same dog (\$21) each
Sunday (3)	First OBED Entry (\$28)	\$	Add'l Sun OBED (3) entries, same dog (\$21) each
Sunday (4)	First OBED Entry (\$28)	\$	Add'l Sun OBED (4) entries, same dog (\$21) each
RALLY: Enter fee amount in each box		Enter fee amount in each box	
Saturday (1)	First RALLY Entry (\$28)	\$	Second Sat RALLY (1) entry, same dog (\$21)
Saturday (2)	First RALLY Entry (\$28)	\$	Second Sat RALLY (2) entry, same dog (\$21)
Sunday (3)	First RALLY Entry (\$28)	\$	Second Sun RALLY (3) entry, same dog (\$21)
Sunday (4)	First RALLY Entry (\$28)	\$	Second Sun RALLY (4) entry, same dog (\$21)
Catalog pre-order \$10.00		\$	TOTAL FEES
		\$	TOTAL AMOUNT ENCL.

IMPORTANT-Read Carefully Instructions on Reverse Side Before Filling Out. Numbers in the boxes indicate sections of the instructions relevant to the information needed in that box (PLEASE PRINT).

BREED 4		VARIETY 1		SEX
Obedience Class 2	Jump Height	Add'l Obed Class 2	Add'l Obed Class 2	Add'l Obed Class 2
Rally Class 2	Jump Height	Add'l Rally Class 2	Add'l Rally Class 2	Add'l Rally Class 2
NAME OF JUNIOR HANDLER (if any)			Junior Handler Number	
FULL NAME OF DOG				
Check one and enter number		DATE OF BIRTH		
<input type="checkbox"/> AKC® NO.		PLACE OF BIRTH (list country)		
<input type="checkbox"/> PAL/ILP NO.				
<input type="checkbox"/> FOREIGN NO.				
BREEDER				
SIRE				
DAM				
ACTUAL OWNER(S) 3				
OWNER'S ADDRESS				
CITY		STATE	ZIP	
HANDLER:				
I CERTIFY that I am the actual owner of the dog, or that I am the duly authorized agent of the actual owner whose name I have entered above. In consideration of the acceptance of this entry, I (we) agree to abide by the rules and regulations of The American Kennel Club in effect at the time of this event, and by any additional rules and regulations appearing in the premium list for this event, and further agree to be bound by the "Agreement" printed on the reverse side of this entry form. I (we) certify and represent that the dog entered is not a hazard to persons or other dogs. This entry is submitted for acceptance on the foregoing representation and Agreement. I (we) agree to conduct myself (ourselves) in accordance with all such Rules and Regulations (including all provisions applying to discipline) and to abide by any decisions made in accord with them.				
SIGNATURE of owner or his agent (duly authorized to make this entry)				
EMAIL			TELEPHONE	
(By providing email address, you signify willingness to receive confirmations and judging program via email.)				
Are you a new exhibitor? YES <input type="checkbox"/> NO <input type="checkbox"/>				

AKC Rules, Regulations, Policies and Guidelines are available on the American Kennel Club Web site, [www.akc.org](http://www.akc.org)

**INSTRUCTIONS 1.(Variety)** if you are entering a dog of breed in which there are varieties for show purposes, please designate the particular variety you are entering, i.e., Cocker Spaniel (solid color black, ASCOB, parti color), Beagles (not exceeding 13 in., over 13 in. but not exceeding 15 in.), Dachshunds (longhaired, smooth, wirehaired), Collies (rough, smooth), Bull Terriers (colored, white), Manchester Terriers (standard, toy), Chihuahuas (smooth coat, long coat), English Toy Spaniels (King Charles and Ruby, Blenheim and Prince Charles), Poodles (toy, miniature, standard). **2. (Event Class)** Consult the classification in this premium list. If the event class in which you are entering your dog is divided, then, in addition to designating the class, specify the particular division of the class in which you are entering your dog, i.e. A or B division. **3. (Owner)** A dog must be entered in the name of the person who actually owned it at the time entries for an event closed. If a registered dog has been acquired by a new owner it must be entered in the name of its new owner in any event for which entries closed after the date of acquirement, regardless of whether the new owner has received the registration certificate indicating that the dog is recorded in his/her name. State on entry form whether transfer application has been mailed to the AKC. (For complete rules, refer to Chapter 11, Section 3.) **4. (Canine Partners)** Dogs listed in the AKC Canine Partners<sup>SM</sup> Program may be eligible to enter all-breed AKC Obedience trials at the club's option. These dogs should be listed as All American Dog and must include their AKC Number on the entry form and check the AKC No. box. Sire and Dam information shall remain blank for mixed breed entrants.

**AGREEMENT** I certify that I am the actual owner of the dog, or that I am the duly authorized agent of the actual owner whose name I have entered above. In consideration of the acceptance of this entry, I (we) agree to abide by the rules and regulations of The American Kennel Club in effect at the time of this event, and any additional rules and regulations appearing in the premium list of this event and entry form and any decision made in accord with them. I (we) agree that the club holding this event has the right to refuse this entry for cause which the club shall deem sufficient. I (we) certify and represent that the dog entered is not a hazard to persons or other dogs. In consideration of the acceptance of this entry and of the holding of this event and of the opportunity to have the dog judged and to win prizes, ribbons, or trophies, I (we) agree to hold the AKC, the event-giving club, their members, directors, governors, officers, agents, superintendents or event secretary and the owner and/or lessor of the premises and any provider of services that are necessary to hold this event and any employees or volunteers of the aforementioned parties, and any AKC approved judge, judging at this event, harmless from any claim for loss or injury which may be alleged to have been caused directly or indirectly to any person or thing by the act of this dog while in or about the event premises or grounds or near any entrance thereto, and I (we) personally assume all responsibility and liability for any such claim; and I (we) further agree to hold the aforementioned parties harmless from any claim for loss, injury or damage to this dog. Additionally, I (we) hereby assume the sole responsibility for and agree to indemnify, defend and save the aforementioned parties harmless from any and all loss and expense (including legal fees) by reason of the liability imposed by law upon any of the aforementioned parties for damage because of bodily injuries, including death at any time resulting therefrom, sustained by any person or persons, including myself (ourselves), or on account of damage to property, arising out of or in consequence of my (our) participation in this event, however such, injuries, death or property damage may be caused, and whether or not the same may have been caused or may be alleged to have been caused by the negligence of the aforementioned parties or any of their employees, agents, or any other person. I (we) agree that the determination of whether the injury is serious shall be made by the event veterinarian and is binding on me (us). I (WE) AGREE THAT ANY CAUSE OF ACTION, CONTROVERSY OR CLAIM ARISING OUT OF OR RELATED TO THE ENTRY, EXHIBITION OR ATTENDANCE AT THE EVENT BETWEEN THE AKC AND THE EVENT-GIVING CLUB (UNLESS OTHERWISE STATED IN THIS PREMIUM LIST) AND MYSELF (OURSELVES) OR AS TO THE CONSTRUCTION, INTERPRETATION AND EFFECT OF THIS AGREEMENT SHALL BE SETTLED BY ARBITRATION PURSUANT TO THE APPLICABLE RULES OF THE AMERICAN ARBITRATION ASSOCIATION. HOWEVER, PRIOR TO ARBITRATION ALL APPLICABLE AKC BYLAWS, RULES, REGULATIONS AND PROCEDURES MUST FIRST BE FOLLOWED AS SET FORTH IN THE AKC CHARTER AND BYLAWS, RULES, REGULATIONS, PUBLISHED POLICIES AND GUIDELINES.

If this entry is for Junior Handler, please give the following information:

AKC JUNIOR HANDLER # \_\_\_\_\_ JR.'S DATE OF BIRTH \_\_\_\_\_  
 The above number MUST be included. Should you not have your Junior Handler number, this may be obtained from the American Kennel Club. Phone: (919) 233-9767.

**By signing the entry form I (we) certify that the Junior Showman does not now, and will not at any time, act as an agent/handler for pay while continuing to compete in Junior Showmanship.**

ADDRESS \_\_\_\_\_

CITY \_\_\_\_\_ STATE \_\_\_\_\_ ZIP \_\_\_\_\_

■ If Junior Handler is not the owner of the dog identified on the face of this form, what is the relationship of the Junior Handler to the Owner? RELATIONSHIP \_\_\_\_\_